

For wood, concrete and steel attachments see Roof Anchorage Detail, Form No. CB-60.

Will conform to seismic code requirements for knock-down or pre-assembled application. (Contact factory for assembled version.)

**STRUCTURALLY CALCULATED KNOCK-DOWN
ROOF CURBS FOR YORK UNITS**

ZR 036-060, ZE 036-072, XP 036-060, ZF 036-072, XN 036-060

ProVent P/N	A	WEIGHT	SEISMIC KIT P/N	WEIGHT
CBKDSUN367208	8"	67 Lbs	KDKITSUN3672	6 Lbs
CBKDSUN367211	11"	79 Lbs		
CBKDSUN367214	14"	91 Lbs		

Meets seismic requirements for the following codes:
CBC 2016
IBC 2015

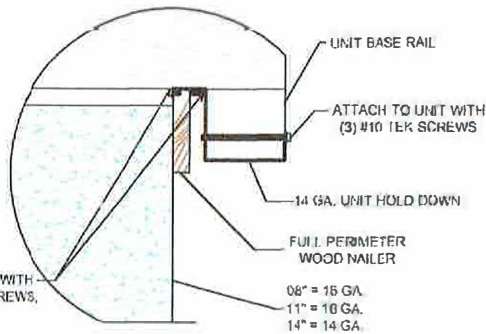
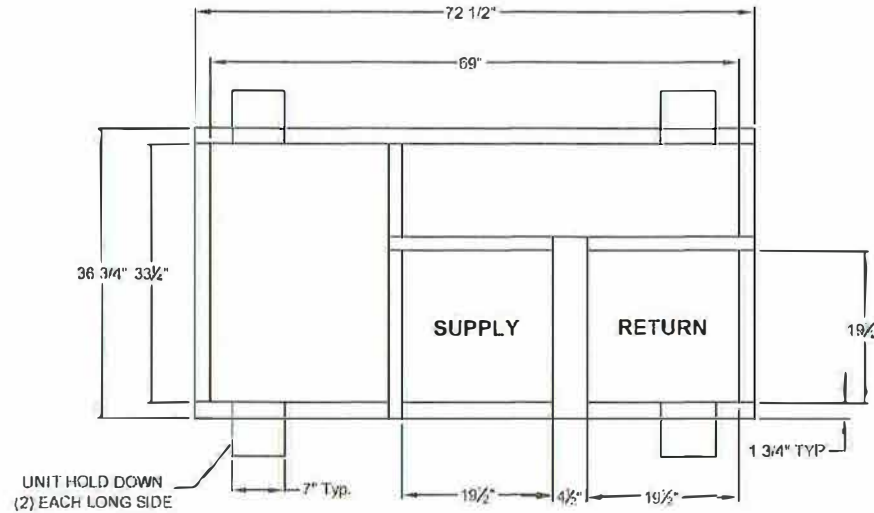
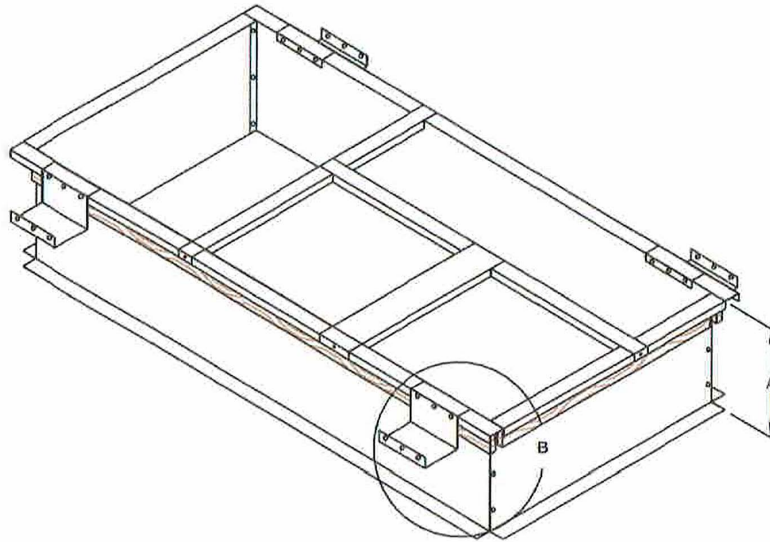

HOLD DOWN DETAIL

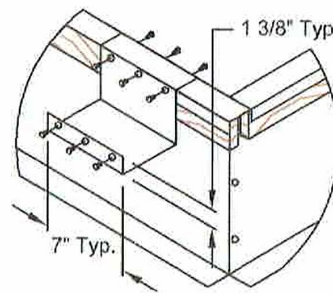

DETAIL B

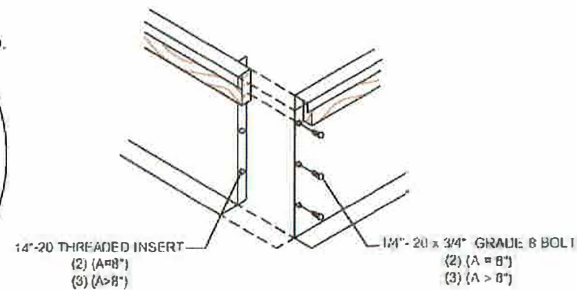

CORNER DETAIL

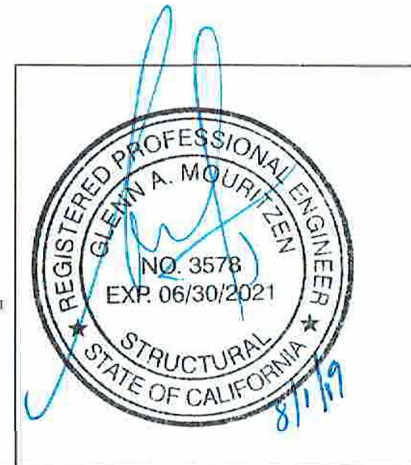

3847 WABASH DRIVE
MIRA LOMA, CA 91725
PHONE (951) 685-1101
FAX (619) 872-9799

SUBMITTED TO: _____
COMPANY: _____
JOB NAME: _____
EQUIPMENT: _____
NOTES: _____

FORM NO:
CBKD-79

DATE:
01/07/19

PART NUMBER:
KDKITSUN3672

REV:
3

DRAWN BY:
ALL