

**FEATURES**

- Roof curb perimeter made of 16 ga. galvanized steel.
- Gasketing package provided.
- Heat treated wood nailer provided.
- Corner flanges are pre-threaded for easy bolt on assembly.
- Pitched, adjustable pitch/adjustable height, welded, different height, isolation and calculated curbs are available.

**NOTES**

- Attach ductwork to roof curb. Flanges of duct rest on top of curb. Support ductwork below the curb.

**KNOCK-DOWN ROOF CURBS FOR YORK UNITS**

**ZJ/ZR 180-300; ZF 210-300; XP 180-240**

ProVent P/N	A	WEIGHT
CBKDSLML183008	8"	131 Lbs
CBKDSLML183011	11"	161 Lbs
CBKDSLML183014	14"	184 Lbs

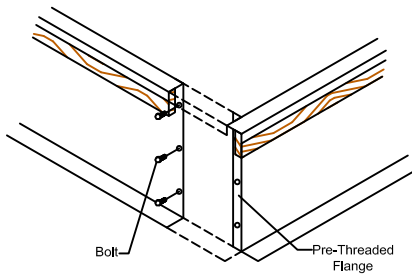
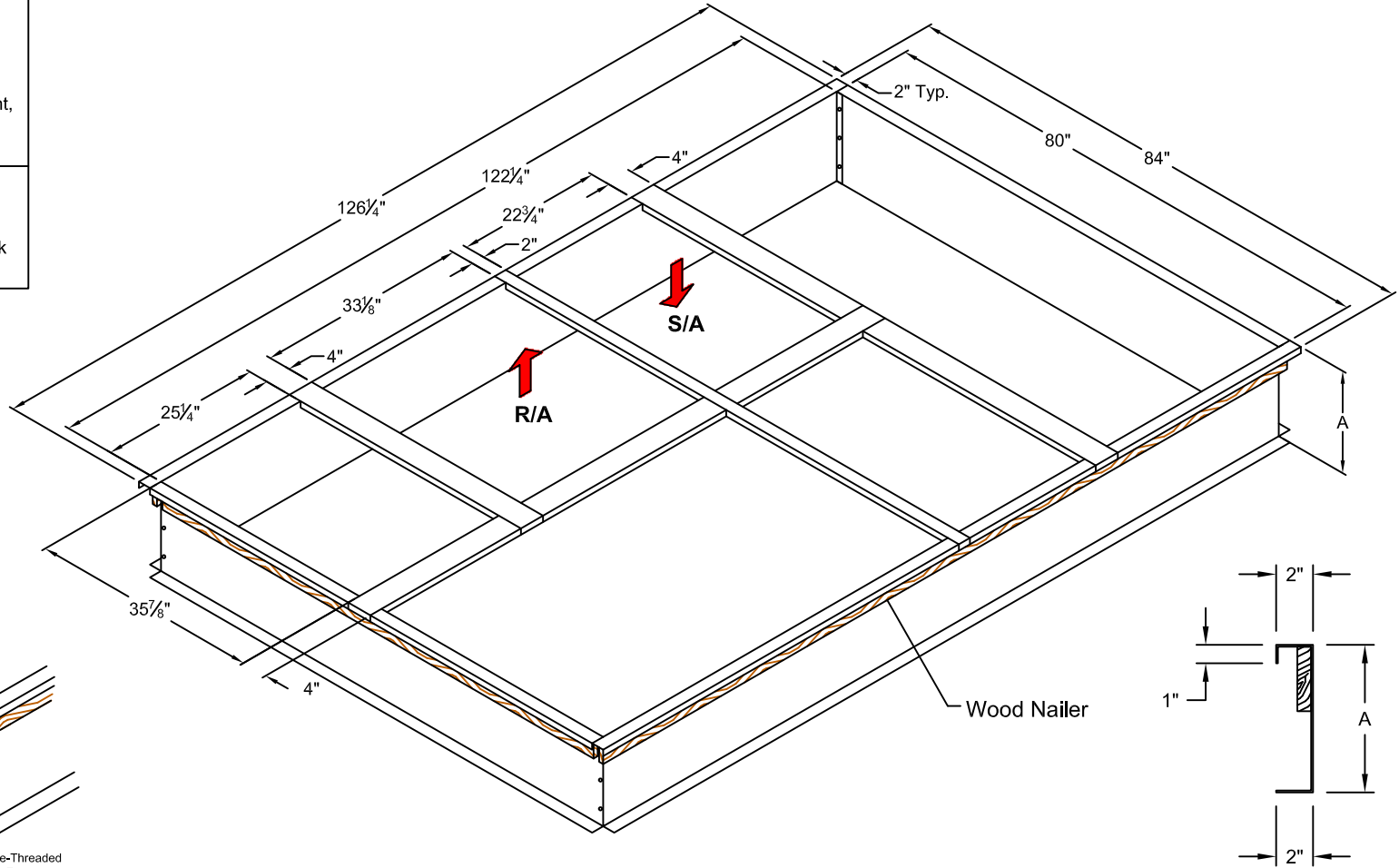

CORNER DETAIL

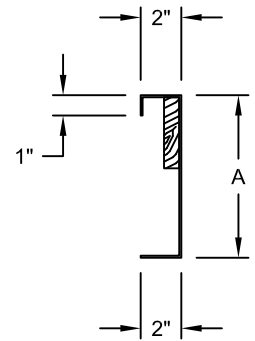

CROSS SECTION DETAIL



3847 WABASH DR.  
MIRA LOMA, CA 91725

PHONE (951) 685-1101  
FAX (619) 872-9799247

SUBMITTED TO: \_\_\_\_\_  
COMPANY: \_\_\_\_\_  
JOB NAME: \_\_\_\_\_  
EQUIPMENT: \_\_\_\_\_  
NOTES: \_\_\_\_\_

FORM NO:  
CBKD-105

DATE:  
08/23/11

REV:  
1

PART NUMBER:  
CBKDSLML1830 SERIES

DRAWN BY:  
FMM